

Table of contents

Location of controls
 Power source
 The HOLD function
 Playback (Basic Play)
 Other functions
 About the remote control
 MD's
 What the displays mean
 Maintenance
 Cautions
 Troubleshooting guide
 Specifications

Supplied Accessories

Check the packing carton for these accessories.

Stereo earphones with cord clip
 (RFEV325P-SA) 1 pc.
 Wired remote control
 (RFEV020P-SM) 1 pc.
 External battery case (RFA1136-H) ... 1 pc.
 Rechargeable Ni-Cd battery with battery carrying case
 (RP-BP62EY-S1) 1 pc.
 Remove the rechargeable battery from their case before use.
 Charger 1 pc.
 For Continental Europe (RP-BC155AEYB)
 For UK (RP-BC155AEYB)
 Carrying case (RFC0045-K) 1 pc.
 (Use numbers indicated when asking for replacement parts.)

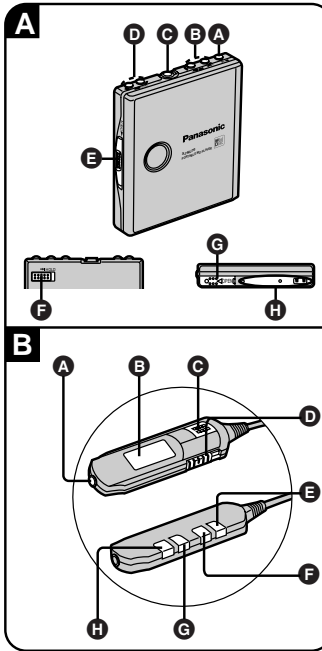

Location of controls

Main unit **A**

- A** Play/stop button (▶/■)
- B** Skip/search buttons (◀◀, ▶▶)
- C** Earphone jack (📎)
- D** Volume buttons (–, VOL, +)
- E** Open switch (◀ OPEN)
- F** Hold switch (HOLD)
- G** Rechargeable battery compartment
- H** Terminal for battery case

Wired remote control **B**

- A** Earphone jack
- B** Display
- C** Play/stop button
- D** Function selector/hold switch (MAIN, SUB, HOLD)
- E** Volume control/tone control button (VOL, +/-EQ)
- F** Volume control/play mode button (VOL, –/PLAY MODE)
- G** Skip/search (forward)/light/display button (▶▶/• LIGHT, ◀ DISP)
- H** Skip/search (backward) button (◀◀)

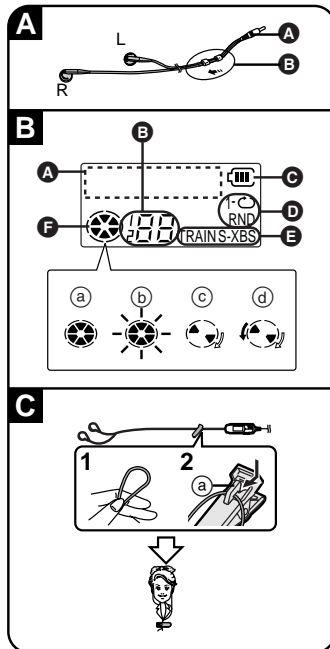

Location of controls

Stereo earphones **A**

- A** Plug
- B** Slider
Slide up to prevent tangling the cord when the earphones are not in use.

Display information **B**

- A** Text/play time
- B** Number of tracks/track number
- C** Battery indication
- D** Play mode
- E** Sound quality
- F** Operation indicator
 - a** Stopped: Fully lights
 - b** Reading TOC: Flashes
 - c** Playing: Rotates slowly
 - d** Skip/Search backward: Rotates anticlockwise quickly
 - forward:** Rotates clockwise quickly

Attaching the cord clip **C**

1. Loosely loop the earphone cord.
2. Fit it firmly into the clip's holder.
 - a** Holder
 Use the clip to keep the cord from tangling.

Do not slide the clip up and down the cord as this may damage the cord.

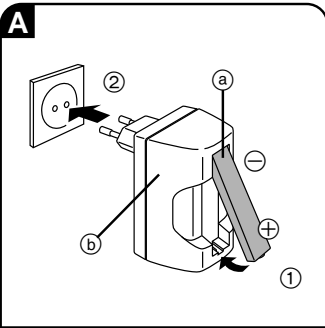

Power source

The rechargeable battery

1. Recharge the battery. **A**

- The battery needs to be recharged before using it for the first time.
- Use only the included charger when recharging.
- ① Rechargeable Ni-Cd battery (included)
- ② Charger (included)

Note

For UK, the shape of the charger is different.

2. After the battery has charged, remove it from the charger and insert into the player. **B**

■ Recharging and playback times

Charging time: Approx 2 hours

Play time: Approx 7 hours

Playback time may be reduced under some conditions.

■ Rechargeable number of times

About 300

The battery has reached the end of its useful life if play time dramatically reduces after recharging.

■ Replacement

Rechargeable Ni-Cd battery (RP-BP62EYS1)

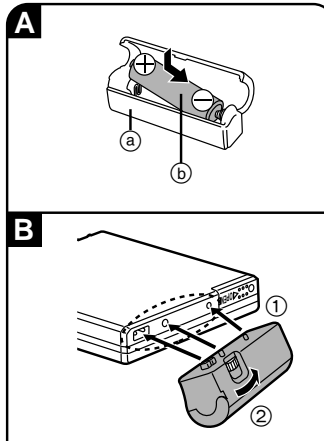
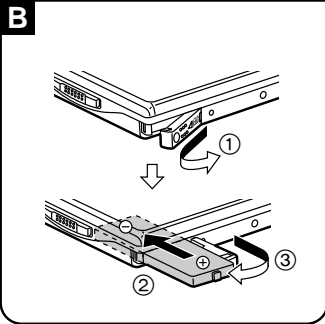

Power source

Dry cell battery

1. Insert the battery into the battery case. **A**

- ① External Battery case (included)
- ② One LR6, AA, UM-3 battery (not included)

2. Attach the case to the player and fix in place with the screw. **B**

■ The battery indicator **C**

The illustration shows how the indicator on the remote control display appears as the battery's power runs down.

When the battery indicator begins to flash, the battery is almost flat and should be replaced or recharged.

■ For longer playback

- You can get about 32 hours of playback if the two types of batteries are used together.
- We recommend using long-life Panasonic alkaline batteries.

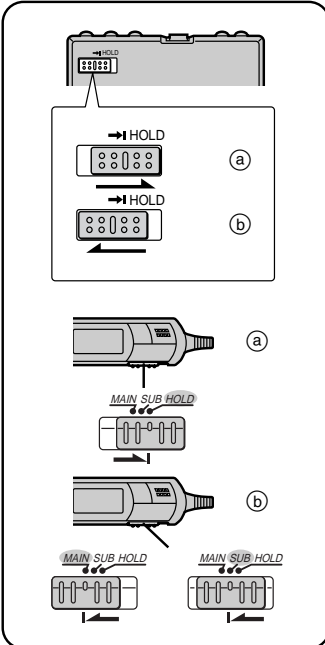
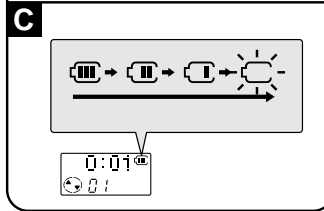
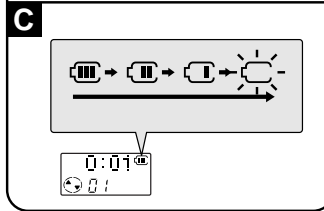

The HOLD function

This function stops the player and remote control from responding when a button is pressed.

- ① Hold mode
- ② Release

Guards against the following

- The unit is powered on accidentally when not in use, causing the batteries to run down.
- A button is accidentally pressed during play, interrupting playback.

Note

There is a HOLD switch on both the player and remote control, each of which works independently of the other.

■ The "HOLD" display

This is displayed for about 2 seconds on the remote control's display panel when the following occurs.

- The main unit is on hold and a button is pressed. (If off, display appears only if [▶/■] is pressed.)
- The remote control's switch is moved to hold. The display also lights for about 5 seconds at this time.

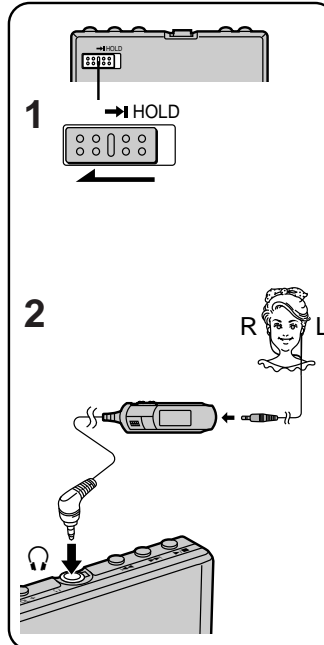

Playback (Basic Play)

1. Release the hold function.
2. Connect the remote control and earphones, then insert the remote control's plug into the earphone jack (Ω) on the player.

Playback (Basic Play)

3. Open the player and insert an MD.

- ① Slide to the right.
- ② Open the lid.
- ③ Insert disc with label facing upward, **push the disc in the center until it locks in place.**
- ④ Close the lid.

After an MD has been inserted the player turns on, reads the information from it, then, after a few seconds, the power goes off again. (The remote control's display lights for about 5 seconds after a disc is inserted.) The name of the disc or song is shown on the display. The information scrolls from right to left across the display if it can not be displayed all at once. (If this information has not been entered onto the disc, then "----" is shown instead.)

- a Total number of tracks
- b Disk name
- c Total playing time
- d Track number
- e Track name
- f Elapsed playing time of each track

Other functions

Skip

This function skips tracks and play begins from the beginning of the selected track.

Main unit **A**

Press during play.

- a Backward
- b Forward

Remote Control **B**

Preparation: Set the selector to MAIN.

Press during play.

- c Backward
- d Forward

For your reference:

You can skip more than one track by repeating this operation. The first skip backwards takes you to the beginning of the current track. Pressing the button in quick succession takes you back to previous tracks.

Playback (Basic Play)

4. Press [▶/■].

"PLAY" is displayed. The player stops automatically when all the tracks on the disc have been played.

5. Adjust the volume.

- a To decrease the volume level
 - b To increase the volume level
- Volume level is 0-25.

To stop the disc **A**

Press [▶/■].

"STOP" is displayed. The unit powers itself off automatically in about 10 seconds.

■ Resume function

The player stores the point at which play was stopped and if [▶/■] on the main unit or the play/stop button on the remote control is pressed again, play begins from that point. This does not work if the player is opened or if the battery is removed. The player starts play from the first track in these cases.

■ Monaural playback function

If a disc was recorded monaurally, the unit automatically switches to monaural playback mode.

Other functions

Search

This function allows you to fast-forward or rewind through tracks.

Main unit **A**

Hold down during play.

- a Backward
- b Forward

Remote Control **B**

Preparation: Set the selector to MAIN.

Hold down during play.

- c Backward
- d Forward

For your reference:

- You cannot fast-forward past the end of the last track. If you release the button at this point, the player stops.
- You cannot rewind beyond the beginning of the first track. The player starts playing the first track if the button is released at this point.

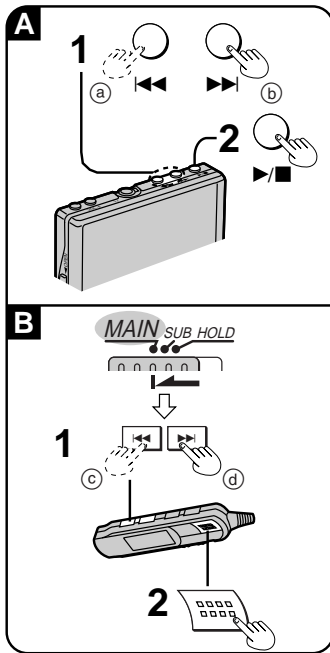

Other functions

Track select

This function allows you to begin listening from a selected track.

Main unit

1. Select a track by pressing while stopped.
 - a) Backward
 - b) Forward
2. Press [▶/■].

Remote Control

Preparation: Set the selector to MAIN.

1. Select a track by pressing while stopped.
 - c) Backward
 - d) Forward
2. Press the play/stop button.

For your reference:

- You can hold the switch or button in place to go through the tracks.
- If [◀◀] is pressed while the first track is selected then the last track is selected.
- If [▶▶] is pressed while the last track is selected then the first track is selected.

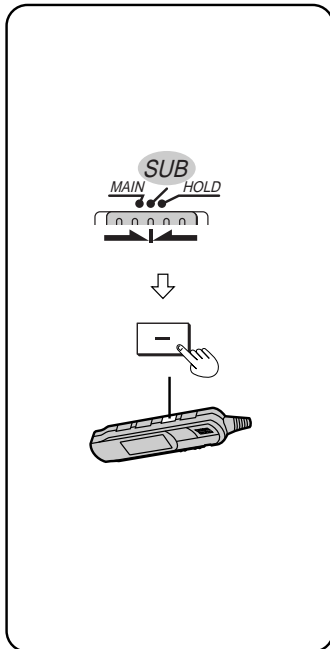

Other functions

Repeat and random play

Remote Control function

Preparation: Set the selector to SUB.

Press [-] when the player is stopped or playing.

Every time the button is pressed the mode changes and an indicator is shown on the display in the following order.

1 track repeat (1-↻)

One track is played over and over.

All track repeat (↻)

All tracks on the disc are repeated.

Random (RND)

All tracks are played randomly once each then the player stops automatically.

Normal (no indicator is shown)

Note

If you have selected the mode when the player was stopped, press the play/stop button.

For your reference:

- When the player is in the all-track repeat mode, you can skip and search beyond the first and last track.
- You cannot skip or search back to a track that has already been played when in the random mode.
- Reset after changing discs.

Other functions

Sound quality

Remote Control function

Preparation: Set the selector to **SUB**. There are three sound quality modes to choose from.

Press [+] when the player is stopped or playing.

Every time the button is pressed the mode changes and an indicator is shown on the display in the following order.

S-XBS ←
Increases the power of the bass sounds.

TRAIN
Reduces sounds that may annoy others when you are using the player in a public place.

↓
Normal (no indicator is shown)

About the remote control

Basic operation

Preparation:

Set the selector to **MAIN** to release the hold mode. **A**
(The remote control can be operated regardless of the hold mode of the unit.)

To start playback **B**

Press once during off.
"PLAY" is displayed.

To adjust the volume **C**

(a) To decrease the volume level
(b) To increase the volume level
Volume level is 0–25.

To stop the disc **D**

Press once during play.
"STOP" is displayed.

Note

If the display on the remote control disappears or seems unusual, disconnect the remote control then plug it in again firmly.

[Refer to "Other functions" for other operations.]

About the remote control

About the remote control

The display

The display lights for about 5 seconds when an operation is done on the unit or remote control. It remains lit for up to 20 seconds while a track or disc name is scrolling on the screen.

■ Checking the display **A**

Preparation: Set the selector to **SUB**.

Press [▶▶/• LIGHT, • DISP].
The display lights for 5 seconds.

■ Adjusting the display's contrast **B**

Preparation:

1. Start playback.
2. Put the main unit in hold.
3. Slide the selector to **MAIN**.

Press and hold [▶/■] on the main unit and press [+] or **[–]** on the remote control to adjust the contrast.

+ : darker, – : lighter

About the remote control

■ Changing the remote control's display

Preparation: Set the selector to **SUB**.

Press and hold [▶▶/• LIGHT, • DISP].

- (a)** Elapsed time of the current track
- (b)** Track number in play
- (c)** Name of the track
- (d)** Name of the disc
- (e)** Total playing time
- (f)** Total number of tracks

- ▶: Changes each time the button is pressed.
- ⏏: Changes automatically after a few seconds.

("-▶▶-" is displayed when the disc contains no track or disc names.)

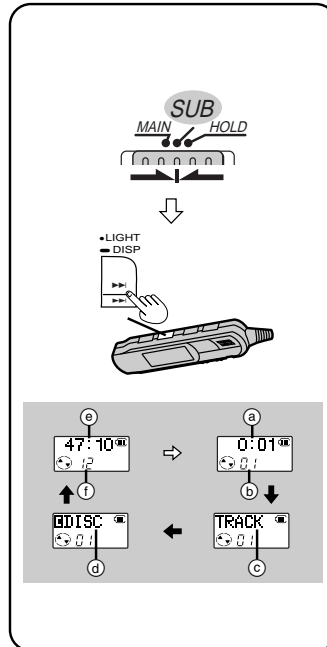
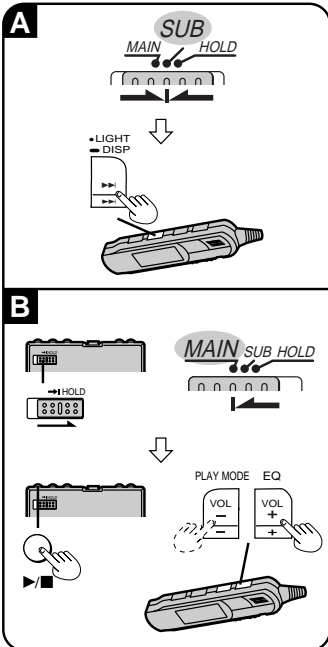
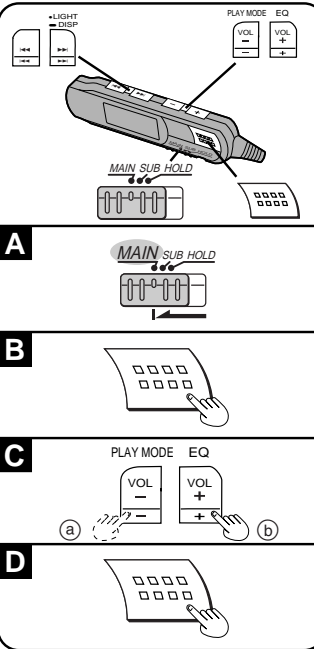
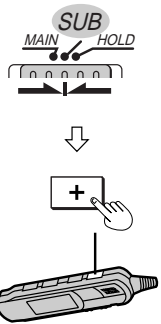

About the remote control

The operation tone

A tone sounds when a button on the remote control is pressed.

Skip

forward: Beep Beep
backward: Beep Beep Beep
other functions: Beep

The tone can be turned on and off.

(a) To turn on:

Press and hold the play/stop button until "Beep ON" appears.

(b) To turn off:

Press and hold the play/stop button until "Beep OFF" appears.

Note

If the above is done during play, play stops and power automatically goes off in about ten seconds.

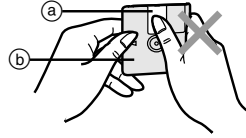
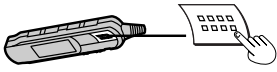

MD's

■ To maintain the best quality sound

Take care with storage

Do not place the disc in the following places:

- Places where it is exposed to direct sunlight, or extremely hot places like cars
- Humid places like bathrooms
- Sandy or dusty locations

Leave the shutter closed.

If the shutter is accidentally opened, close it again as quickly as possible. Do not touch the disc inside.

(a) Shutter

Disc care

Wipe with a soft, dry cloth if the cartridge gathers dust.

(b) Cartridge

What the displays mean

Display	Meaning
BLANK	Nothing is recorded on the disc currently loaded.
HOLD	Hold is on.
NoDISC	There is no disc in the unit.
T-READ	Reading TOC
ERROR	A problem has occurred while the unit was reading TOC, or during play.

TOC: Table of contents

Information about the position, division, and order of tracks on the disc.

Maintenance

■ Main unit

Wipe the main unit with a soft, dry cloth.

If the player becomes particularly dirty, use a cloth dipped in a mild detergent solution and then wipe dry.

- Do not use alcohol or thinners to clean the player.
- Before using chemically treated cloths, read their instructions carefully.

Cautions

■ The main unit

Avoid the following as they may damage the unit.

- Dropping and other strong impacts
- Rain
- High humidity areas such as bathrooms
- Dusty areas such as warehouses
- High temperatures such as near heating appliances
- This unit is resistant to the effects of vibration but sound may skip if the vibration is constant.

■ The earphones

Leave a reasonable amount of slack in the cord if you wind it around the main unit.

■ The rechargeable battery

- Do not peel off the plastic covering on the rechargeable battery.
- The battery may not last as long as usual after recharging if it has not been used for a long period. After a number of uses it will return to normal.
- The battery may heat up while charging but this is normal.
- Do not attempt to recharge the battery for over twelve hours. Overcharging reduces the life of the battery.
- The charger can cause interference to radio reception so do not recharge the battery near a radio in use.

Notice about the rechargeable battery

The battery is designated recyclable.
Please follow your local recycling regulations.

Cautions

■ Dry cell batteries/rechargeable batteries

- Insert the batteries in the correct polarities to avoid leakage and damage to this unit.
- Remove all the batteries if the set will not be used for a long period of time.

■ Precautions for Listening with the Headphones or Earphones

- Do not play your headphones or earphones at a high volume. Hearing experts advise against continuous extended play.
- If you experience a ringing in your ears, reduce volume or discontinue use.
- Do not use while operating a motorized vehicle. It may create a traffic hazard and is illegal in many areas.
- You should use extreme caution or temporarily discontinue use in potentially hazardous situations.
- Even if your headphones or earphones is an open-air type designed to let you hear outside sounds, don't turn up the volume so high that you can't hear what's around you.

US and foreign patents licenced from Dolby Laboratories Licensing Coporation.

CAUTION!

THIS PRODUCT UTILIZES A LASER. USE OF CONTROLS OR ADJUSTMENTS OR PERFORMANCE OF PROCEDURES OTHER THAN THOSE SPECIFIED HEREIN MAY RESULT IN HAZARDOUS RADIATION EXPOSURE. DO NOT OPEN COVERS AND DO NOT REPAIR YOURSELF. REFER SERVICING TO QUALIFIED PERSONNEL.

WARNING:

TO REDUCE THE RISK OF FIRE, ELECTRIC SHOCK OR PRODUCT DAMAGE, DO NOT EXPOSE THIS APPLIANCE TO RAIN, SPLASHING, DRIPPING OR MOISTURE.

Marking sign is located on bottom of the unit.

Troubleshooting guide

Before requesting service for this unit, check the chart below for a possible cause of the problem you are experiencing. Some simple checks or a minor adjustment on your part may eliminate the problem and restore proper operation. If you are in doubt about some of the check points, or if the remedies indicated in the chart do not solve the problem, refer to the directory of Authorized Service Centers (enclosed with this unit) to locate a convenient service center, or consult your dealer for instructions.

Problem	Check this
Player doesn't operate at all.	<ul style="list-style-type: none">● Is the hold function on?● Is there a disc loaded?● Have the batteries run down?● Has condensation formed on the disc or lens? (Wait an hour before use.)
No sound from the earphones. No response from the remote control.	<ul style="list-style-type: none">● Has the volume been turned down too far?● Have the plugs on the earphone and remote control been inserted correctly? (Try plugging it in again.)● Are the plugs dirty?
The player doesn't play in order from the first track.	<ul style="list-style-type: none">● Has the play mode been switched to RANDOM?● Did you stop the disc part way through the last time listened to it?
Noise	Are you using the player near a strong magnet, such as may be found in a television?